

Band Course - Type BC19

Stone	* Dim	Quantity
BC19A	491mm	4 no.
BC19B	544mm	4 no.
BC19C	600mm	22 no.

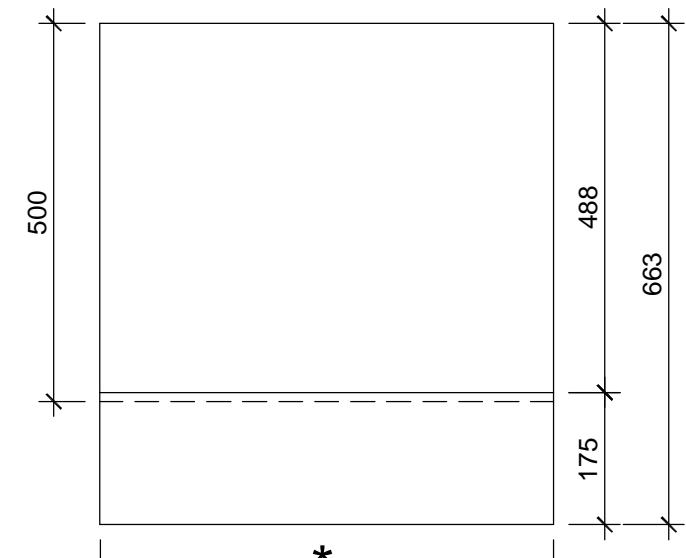
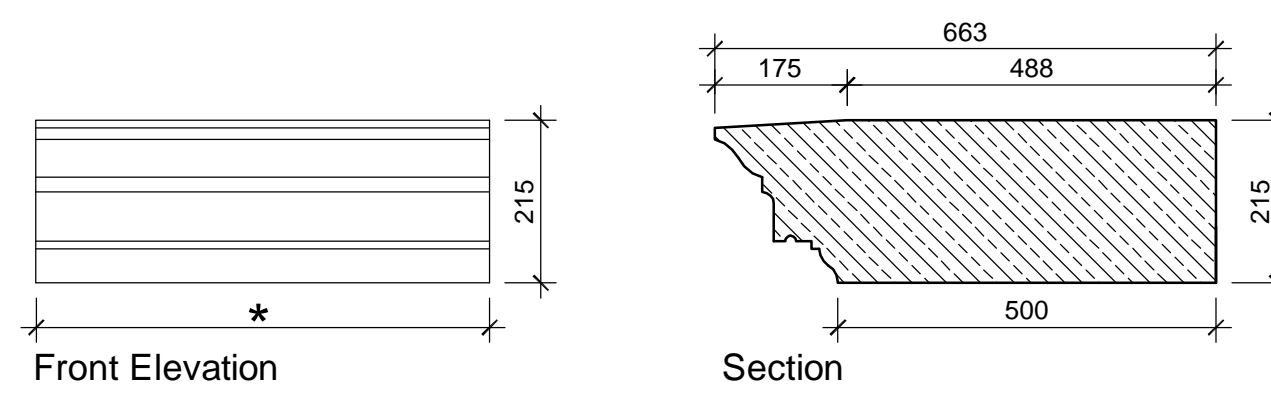

Band Course - Type BC20

Stone	* Dim	Quantity
BC20A	528mm	2 no.
BC20B	600mm	7 no.

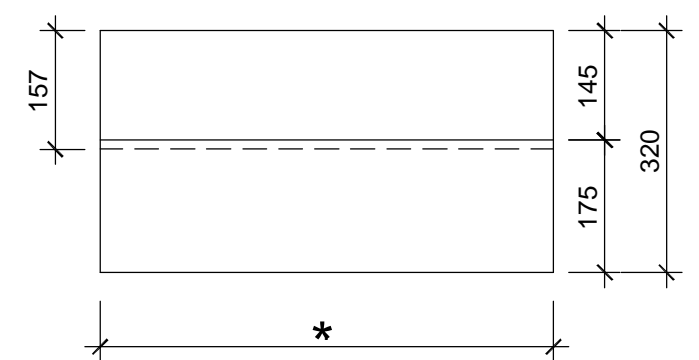
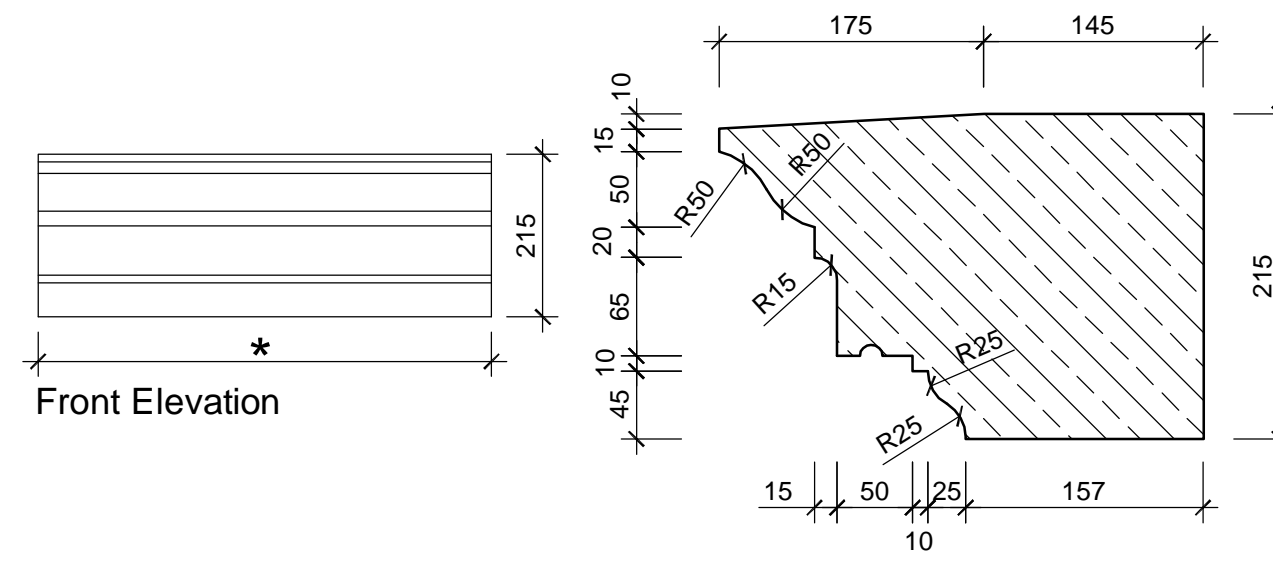

Band Course - Type BC21

Stone	* Dim	Quantity
BC21A	273mm	8 no.
BC21C	600mm	28 no.

Typical Section Band Course BC21 Scale 1:5

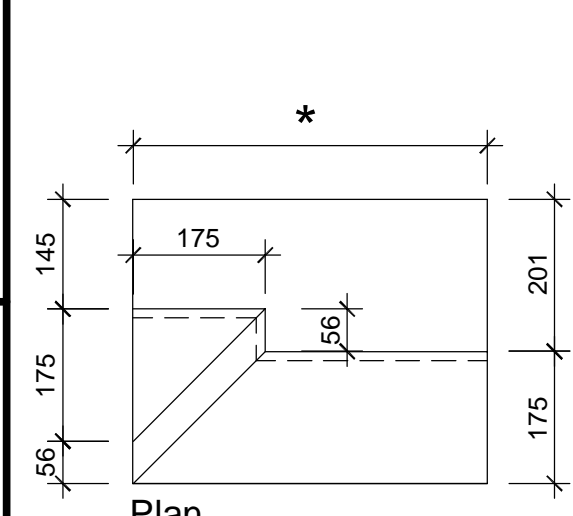
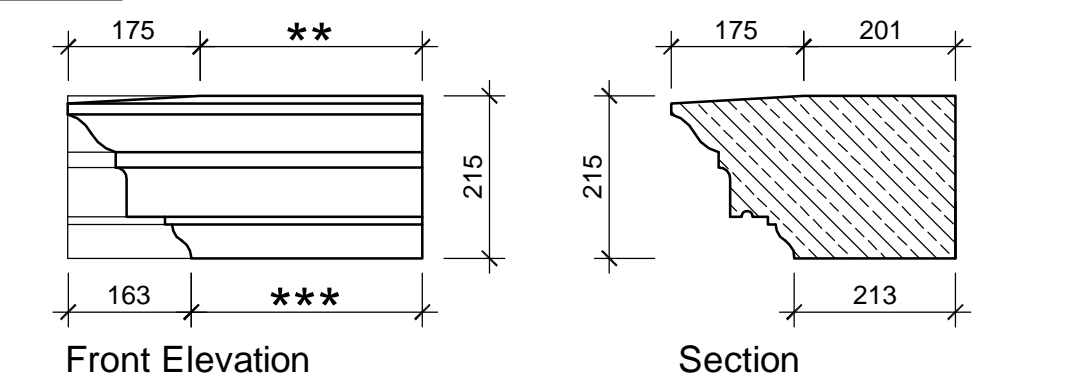

Band Course - Type BC25A  
Left Hand (as drawn) Right Hand (Handed)

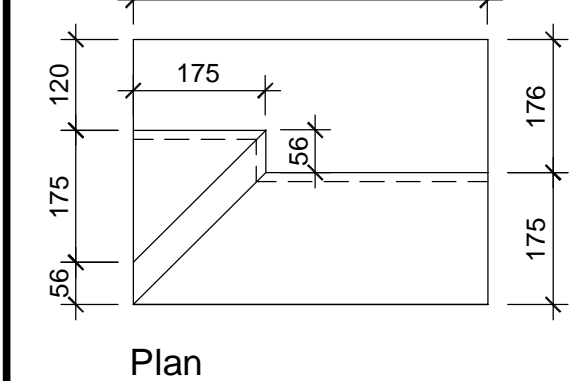
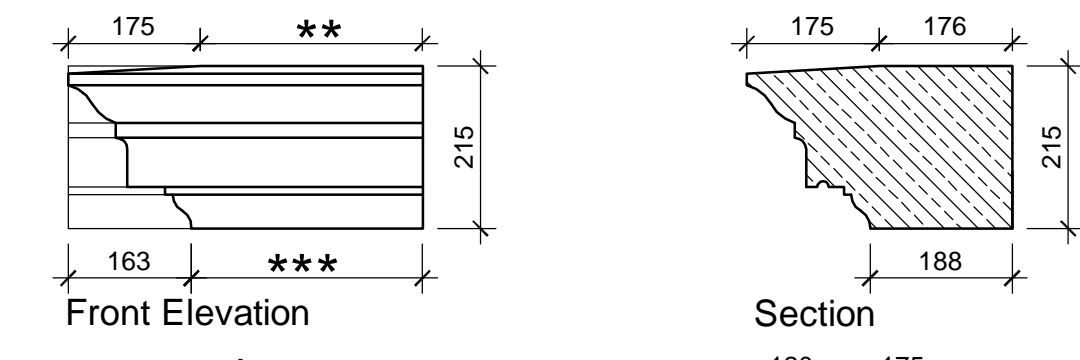

Band Course - Type BC25B  
Left Hand (as drawn) Right Hand (Handed)

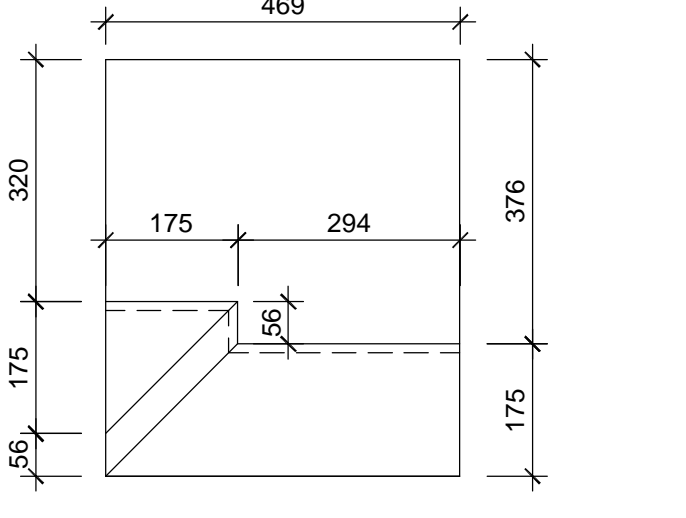
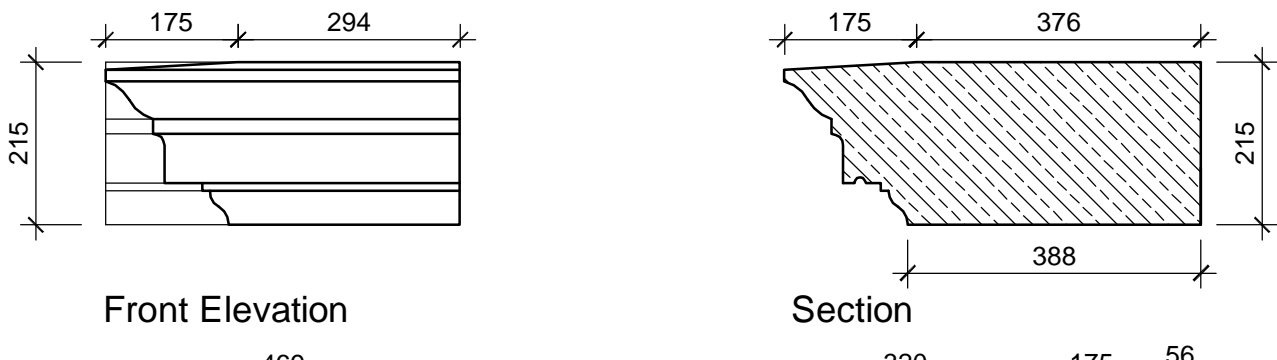

Band Course - Type BC22  
2 no Left Hand (as drawn)  
2 no Right Hand (Handed)

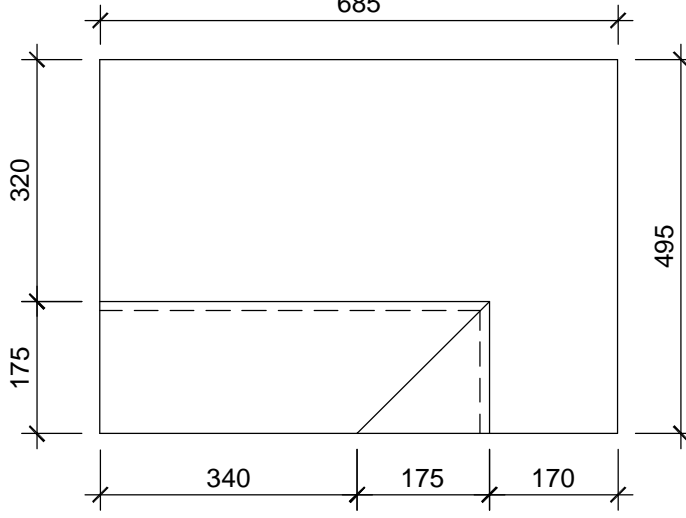
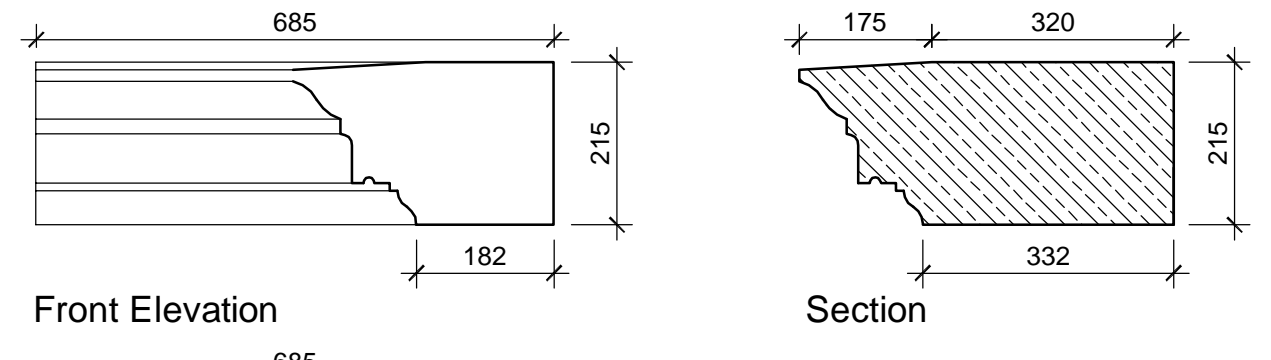

Band Course - Type BC23  
3 no Left Hand (as drawn)  
3 no Right Hand (Handed)

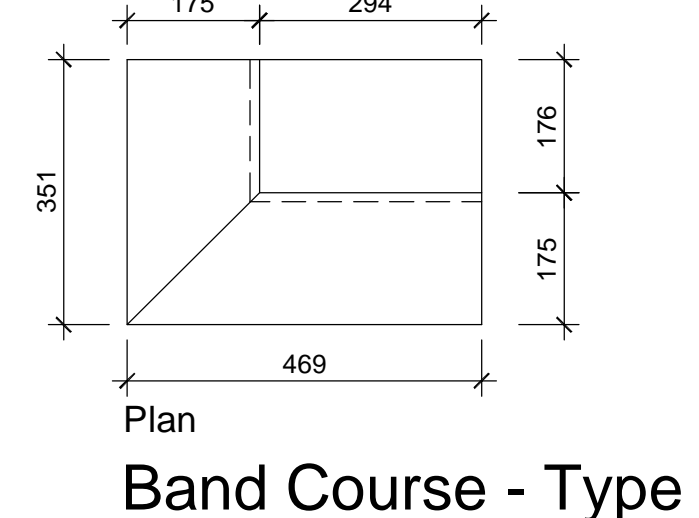
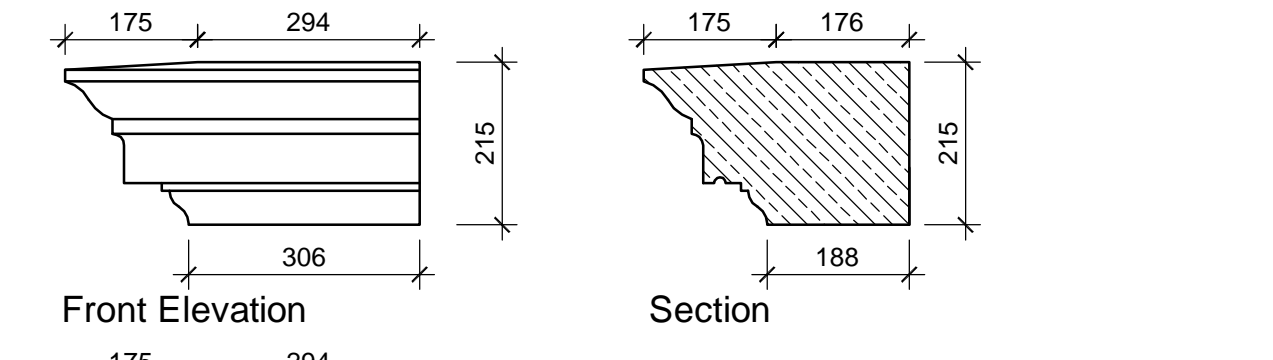

Band Course - Type BC24  
4 no Left Hand (as drawn)  
4 no Right Hand (Handed)

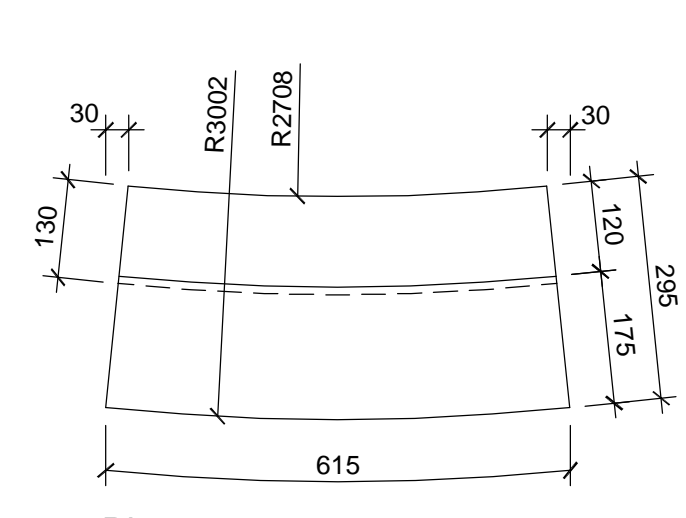
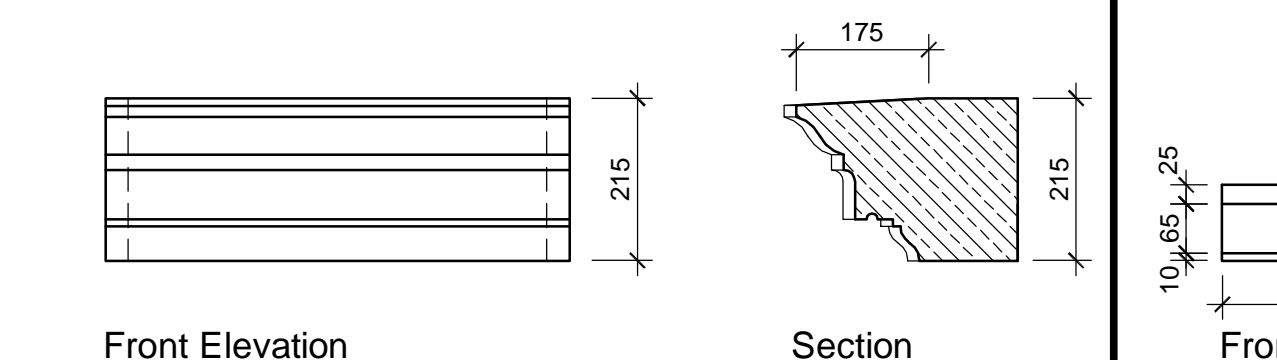

Band Course - Type BC26  
32 no required

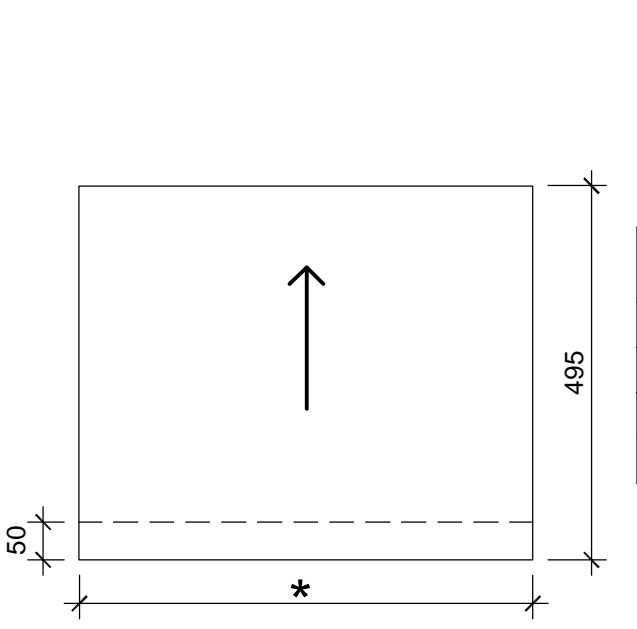
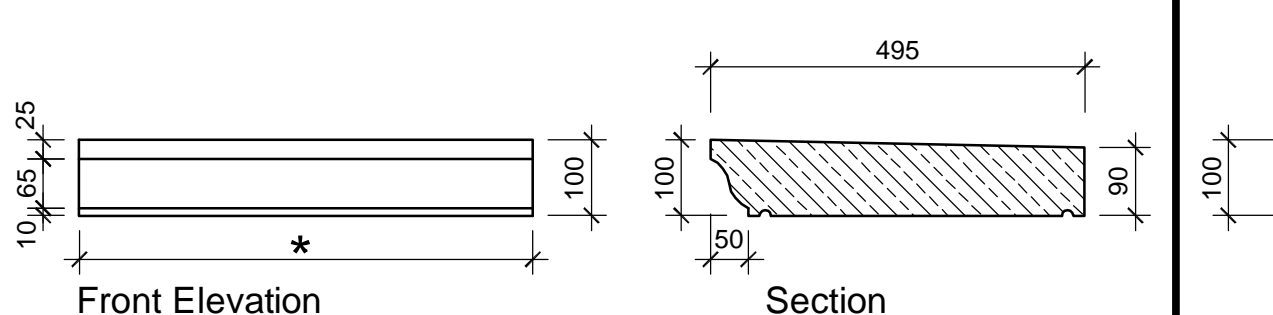

Band Course - Type BC27

Stone	* Dim	Quantity
BC27A	328mm	4 no.
BC27B	387mm	8 no.
BC27C	415mm	2 no.
BC27D	600mm	298 no.

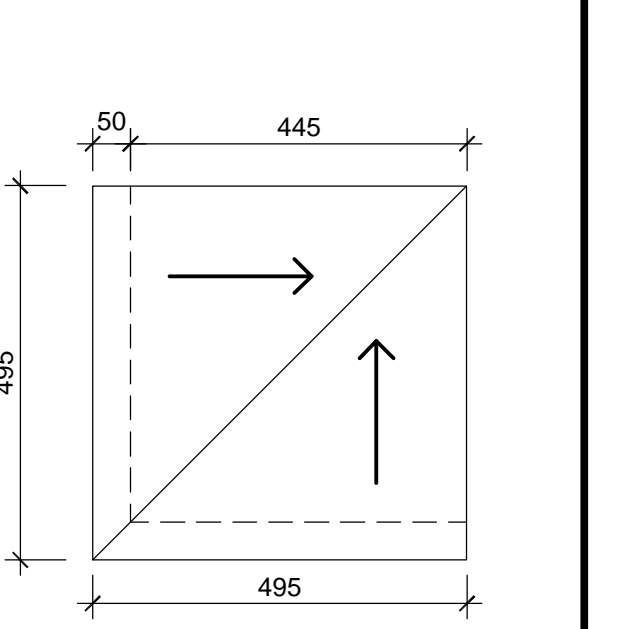
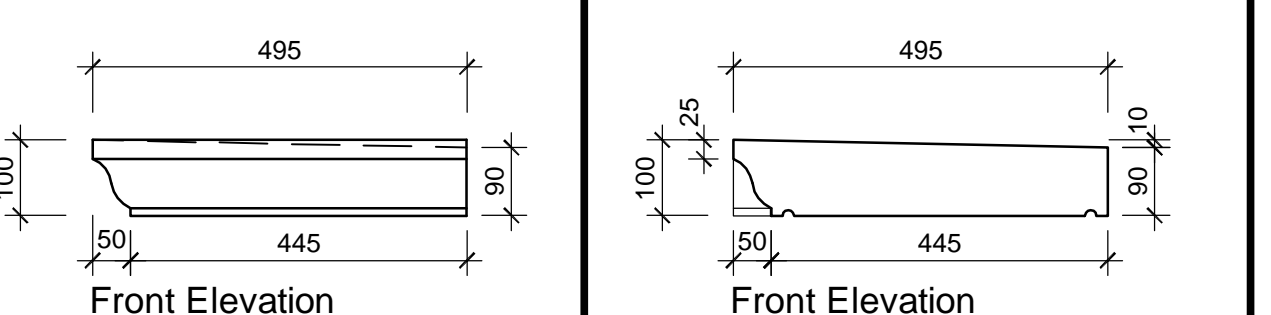

Band Course - Type BC28  
27 no required

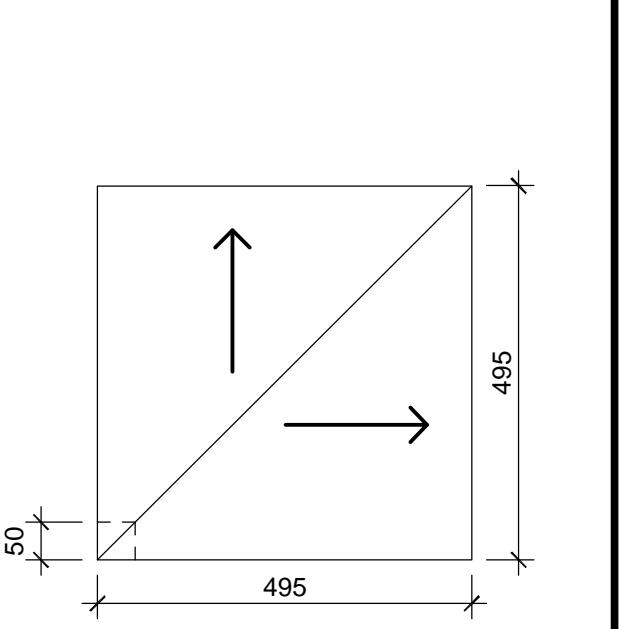
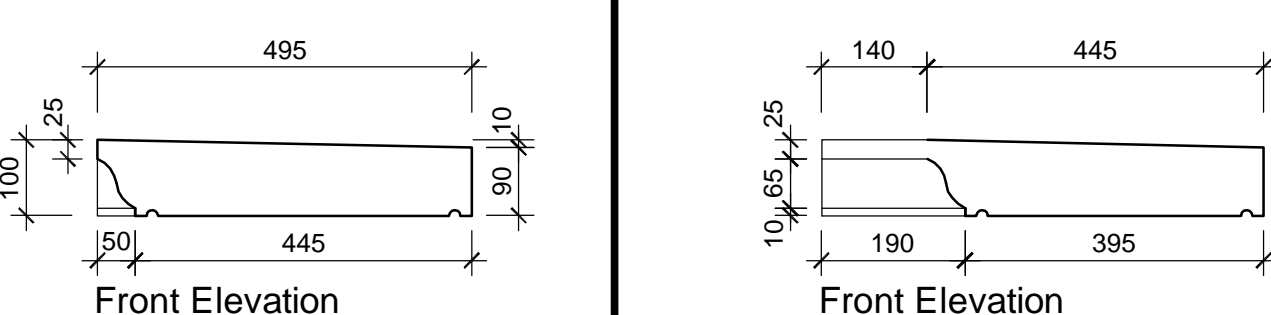

Band Course - Type BC29  
7 no required

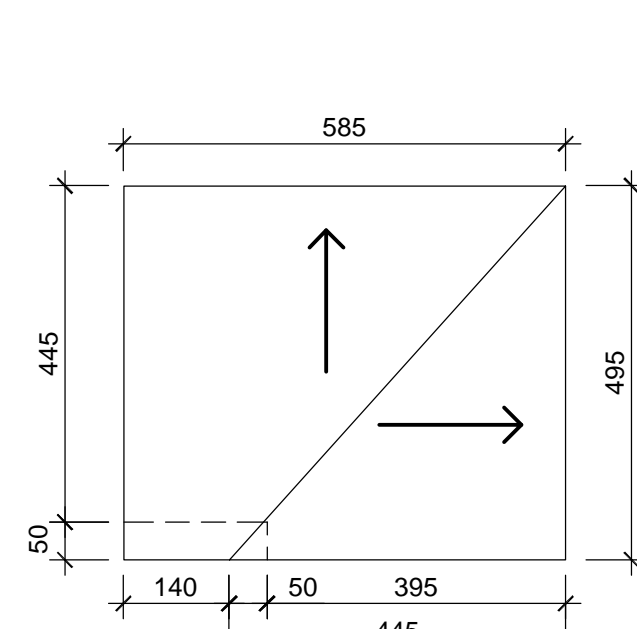
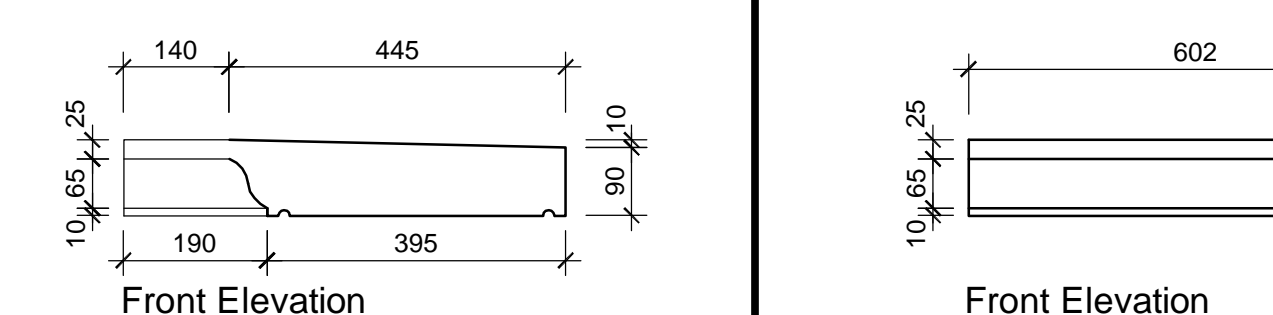

Band Course - Type BC30  
1 no Left Hand (as drawn)  
1 no Right Hand (Handed)

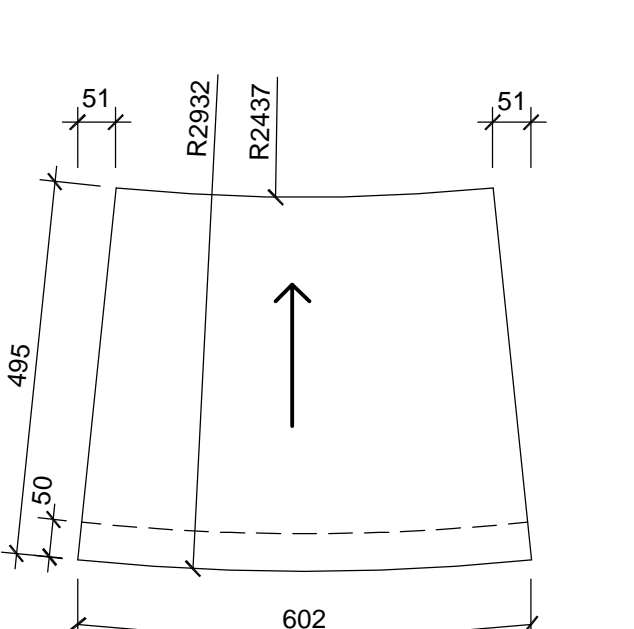
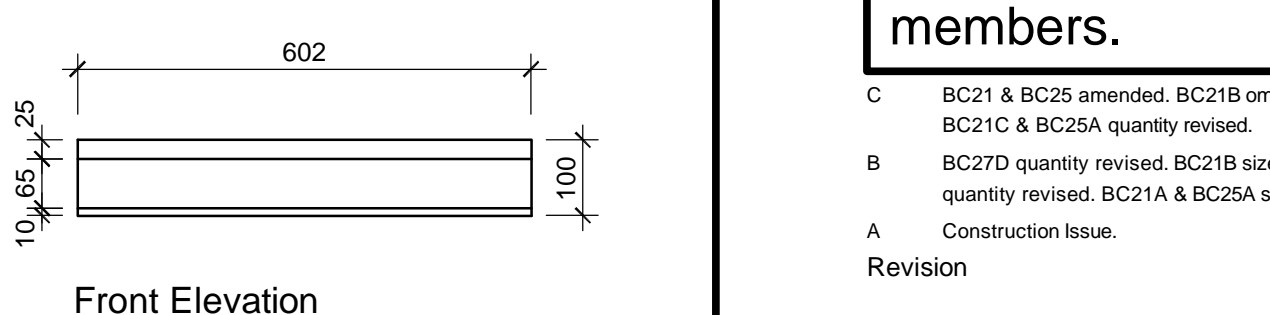

Band Course - Type BC31  
30 no required

Stone	* Dim	** Dim	*** Dim	Quantity
BC25ALH	469mm	294mm	306mm	6 no.
BC25ARH	469mm	294mm	306mm	6 no.
BC25BLH	586mm	411mm	423mm	4 no.
BC25BRH	586mm	411mm	423mm	4 no.

**Notes**

- All quantities shown are actual quantities required for each plot. Any excess (for breakage etc.) should be allowed for by the surveyor.
- All stone components are to be smooth PORTLAND STONE finish.
- All components over 25kg are to have recessed lifting eye sockets cast in.
- Any reinforcement deemed necessary by the supplier for safe handling and transportation is to be included.
- Details indicated allow for manufacturing in wet cast acid etched concrete. Details and unit sizes will vary if dry cast is selected.
- Minimum reinforcement for structural members is noted on these drawings. Supplier to provide all other necessary reinforcement in accordance with normal standard / good practice.
- Reinforcement must be provided with 40mm concrete cover. Where ever this cannot be achieved the supplier will be required to use stainless steel reinforcement.
- Supplier will be required to determine both quantities and provide bar bending schedules for reinforcement as necessary - all for suppliers own use.
- Lapped joints in reinforcement bars for stonework concrete will **not** be permitted.
- Concrete strength for all structural stonework and cavity walls to be 35N/mm<sup>2</sup> at 28 days with 10mm max. aggregate size.
- Supplier to incorporate and supply all necessary fixings in accordance with normal standard / good practice, for all stonework / concrete members. (e.g. dowels, straps, ties, support brackets etc.)

Stone manufacturer to design & detail all units & provide all structural reinforcement to all stone units shown on this drawing which are all load bearing members.

C	BC21 & BC25 amended. BC21B omitted. BC21C & BC25A quantity revised.	14.01.14
B	BC27D quantity revised. BC21B size and quantity revised. BC21A & BC25A size revised.	07.01.14
A	Construction Issue.	12.07.13
Revision		Date



Octagon Developments Limited  
Weir House Hurst Road  
East Molesey Surrey KT8 9AQ  
T: +44 (0) 208 481 7500  
F: +44 (0) 208 481 7501  
E: Octagon@Octdev.co.uk  
W: www.Octdev.co.uk

Project  
**Overbye, St Georges Hill**

Title  
**Stone Details  
Band Course Details**

Construction		
Scale	Drawn	Date
1:10 1:2	sh	Jun. '13
Job number	Drawing number	Revision
<b>0623</b>	<b>6012</b>	<b>C</b>