

UNDERFLOOR HEATING TO BE PROVIDED THROUGHOUT

N.B. REMOTE MECHANICAL VENTILATION DETAILS TO BE ADDED AT A LATER DATE

Zoned Mood Lighting to be provided in:- all Ground Floor receptions rooms, Pool Complex, Cinema, Entertainment Room, Gym & all 1st Floor Bedrooms, Hall & Landings

NB: a remote power supply for any LCD mood lighting plates should be fitted adjacent to the dimming racks

| Services Legend | |
|--|--|
| Security Light with sensor & manual override | 5 amp Socket |
| External Wall Light - Flairlight 50001.00 GX53 dual emission wall light IP44 | Double Socket Outlet set in floor |
| Low voltage downlights: | 5 amp Socket set in floor |
| a F/OCT1020.10 Flairlight TR light to be positioned over windows | External Waterproof Single Socket Outlet |
| b F/OCT1020.10 Flairlight to be positioned over showers & in porch soffits | Garage Door Control |
| c F/OCT1010.10 Flairlight downlight to be positioned elsewhere | Remote Switch 1200mm above floor (in Utility) |
| d F/OCT1050.10 Flairlight downlight to be positioned over sanitaryware | Light Switch |
| LED Niche Lights: | Mood Lighting Control Plate |
| to: 10402.60 Flairlight LED niche light to be positioned in showers | Digital Dimming Control Switch |
| on 10402.60 Flairlight LED niche light to be positioned over sanitaryware | Remote switch control point |
| (not showers) | CEFL PIR flush mounted |
| a 10042.10 Flairlight FLEDSB5WV Recessed fit bezel LED downlight | CEFL PIR surface mounted |
| c 10022.10 Flairlight FLEDSB5WV Recessed standard bezel LED fixed | Illuminated Bell Push |
| downlight c/w dimmable driver to be positioned elsewhere | Door Chimes |
| e 10002.10 Flairlight LED fixed downlight c/w dimmable LED transformer | Alarm Key Pad |
| f 10001.10 Flairlight LED fixed downlight (non-dimmable) | Alarm Control Panel |
| Recessed floor & step light set into wall @ low level Flairlight 10422.10 Scoop 90 | Video/Audio Entry Unit |
| LED 3158 with remote 7000ma driver Flairlight 10405.00 | Video/Audio Entry Sounder |
| In floor light fitting Flairlight 10400.00 IP67 with remote LED driver | Interconnected mains operated self contained Smoke Alarm complying with BS5446 Part 1 linked to activate every fire alarm automatically. |
| Flairlight 10405.00 | File Detector complying with BS5839-6 |
| Low Energy Pendant Fitting to be specified by Interior Designer | As above c/w flashing beacon warning system |
| Dual emission wall Light Flairlight 10000.00 2 x 3W luminaires | Telephone Point & Datapoint LAN to the back of BTs |
| Wall Light Fitting to be specified | TV/VM Aerial Outlet/SATellite Point |
| Capped Off Light Point with support above for heavy feature light | Database Frontplate K184 - 2 Gang, 4 module |
| Strip Light (garages) | Database Frontplate K184 - 2 Gang, 5 module |
| Batten Holder Fitting | Speaker Outlet |
| LED Tape Flairlight 10441.00 High Intensity Tape requires remote driver | Sentry Consumer Unit |
| External Upfitter Flairlight 50002.00 IP67 Round adjustable buried uplight for GU10 8W LED lamp | Electro/Gas Meter cupboard positions |
| Inset Brick Light Flairlight 50003.00 | Shower pump/Fillinger pump - power supply to be separate from main electrical board, with its own MCB |
| Shaver Socket | External Tap with Internal Isolating Tap |
| 13 amp Switched Socket 450mm above floor | Gas Point & Tap |
| 13 amp Switched Socket 1200mm above floor | Room Temperature Sensors 1200 - 1400mm from f.f.l. |
| Fused Spur with light & switch | Thermostatic Room Temperature Controller (positioned adjacent to Mood Lighting Plate) |
| Immersion 450mm above floor | Digital Boiler Programmer controlling heating & hot water |
| MK Flex outlet | Heated towel rail in bathrooms |
| Surveillance Camera | Dimplex Heater with fused spur |
| Flairlight F22032 1w 300ma LED light IP67 for wall & floor mounting - requires remote LED driver | Ceiling Fan |
| Supply for house lighting | |

Low energy fittings must have a minimum of 5 Watts per fitting, with a minimum of 45 Lumens per Watt. Each fitting must also have a minimum of 400 Lumens

NB: Plasma points are to be positioned 1500mm from flt for all Bedrooms, & 1300mm from flt generally in all other cases, except where there is bespoke joinery

Note:-

All electrical sockets, TV outlets, BT points, alarm panels, lights switches and other service outlets are to be fitted within a zone of 450mm and 1200mm from finished floor level. Kitchen & Bathroom ventilation Mechanical ventilation to kitchens and bathrooms to be provided. Extraction rate to Kitchens to be min. 30 litres/second and provided by an extraction cooker hood or an extraction fan with a min. extraction rate of 60 litres/second. Extraction rate to bathrooms to be min. 15 litres/second achieving 3 air changes with a 15 minutes over run.

Plumbing & Heating Regulations All works to comply with Octagon Developments Ltd., standard specification, the model water byelaws, BS6700 and the specific requirements of the Local Water Authority. A mains fed system shall only be installed when the running pressure in the water authority main is not less than 3 bar G with a min. flow rate of 50 litres/minute. IT SHALL BE THE CONTRACTORS RESPONSIBILITY TO CHECK THE ABOVE REQUIREMENT WITH THE WATER AUTHORITY.

NB see separate drawings for radiator and towel rail locations.

All electrical work required to meet the requirements for Part P (Electrical Safety) must be designed, installed, inspected and tested by a person competent to do so.

Prior to completion the council should be satisfied that Part P has been complied with. This may require an appropriate BS 7671 electrical installation certificate to be issued for the work by a person competent to do so.

This drawing should be read in conjunction with Fire Risk Assessment ref: TM1040401A

Note:-

All lights located in the 1st Floor ceiling of a 3 storey dwelling should be 'Fire Rated' please refer to lighting schedule for references.

All lights located in the 1st Floor ceiling of a 2 storey dwelling should be fitted with an 'air tight box'.

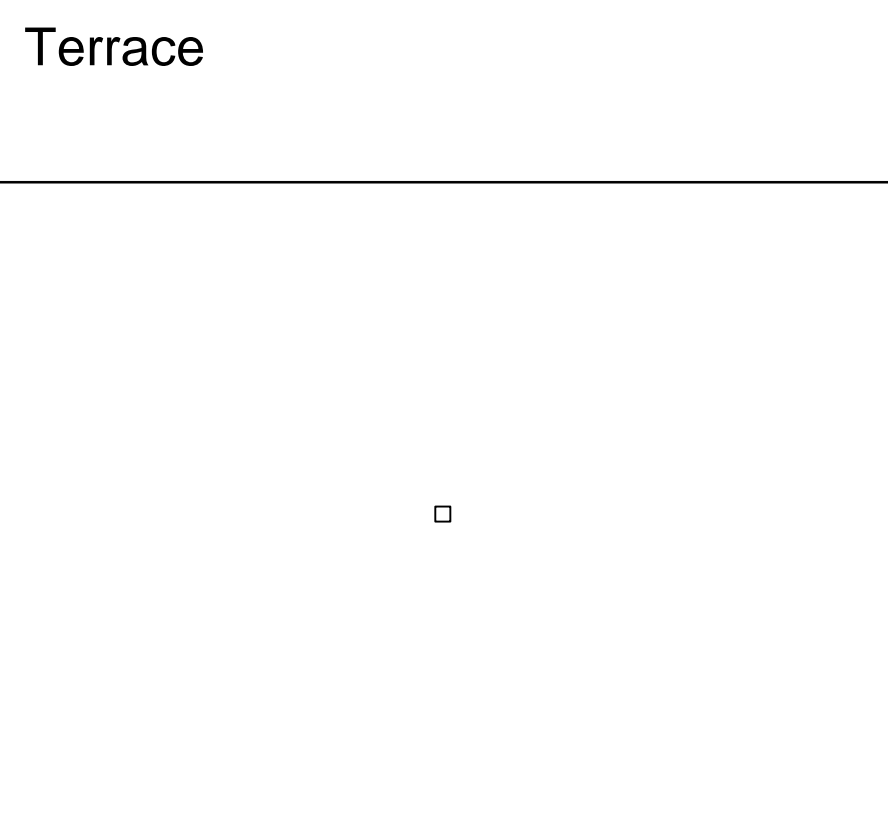
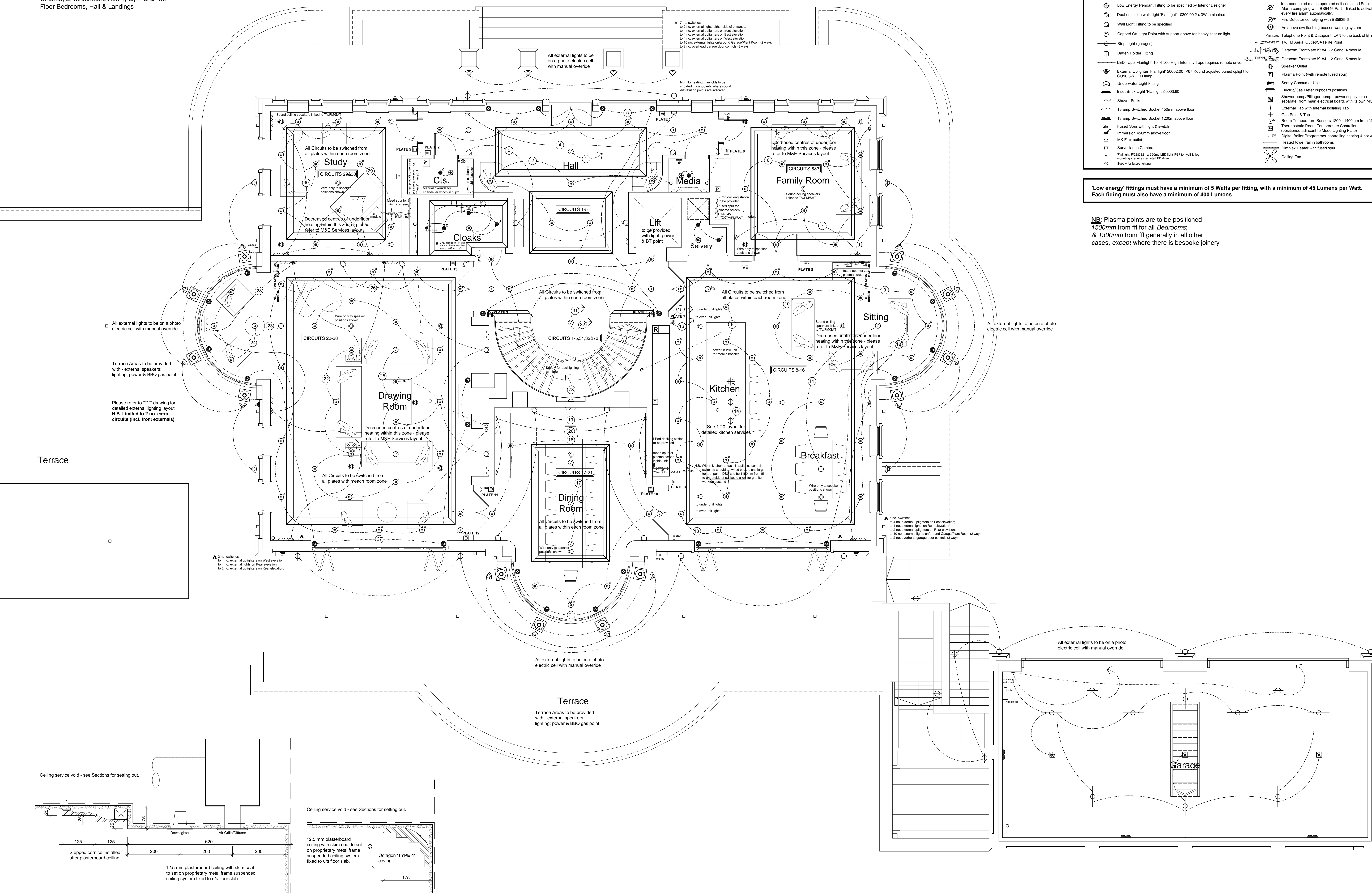

A Preliminary issue 02/10/13

Revision Date

OCTAGON

Octagon Developments Limited
 War House, Hazel Road
 East Molesey, Surrey, KT8 5AY
 T: +44 (0) 208 481 7500
 F: +44 (0) 208 481 7501
 E: octagon@octagon.co.uk
 W: www.octagon.co.uk

Project
Overbye, South Rd, Weybridge
Title
Ground Floor
Services Layout

Status
Construction
Scale 1:50
Job number 0623
Drawn lh
Date Jul '13
Drawing number 2021
Revision A
© Copyright Octagon Developments Limited