

Installation Guidelines For your trades

ELEVATION A: Range Cooker Run

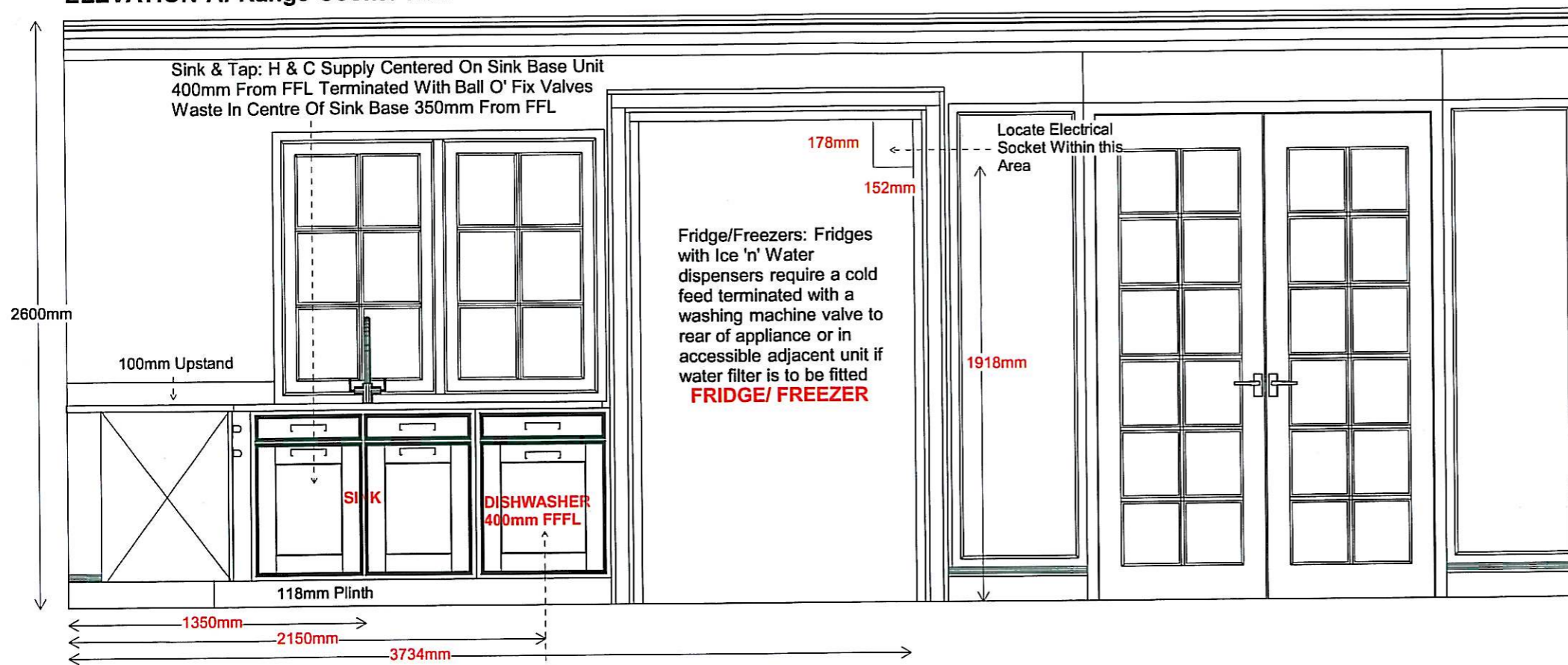

Dishwasher: Requires hardwater cold supply in sink base unit fitted with washing machine valve. Waste to be connected to sink waste by Extreme

Lighting: 1.5m tail required for under unit, wall unit and over lights terminated with a junction box, 200mm Below Top Of Unit

ELEVATION B: Range Cooker Run

Extractor: 2 x Duct Outlets: each requires a 1.5m tail terminated with a junction box for extractor

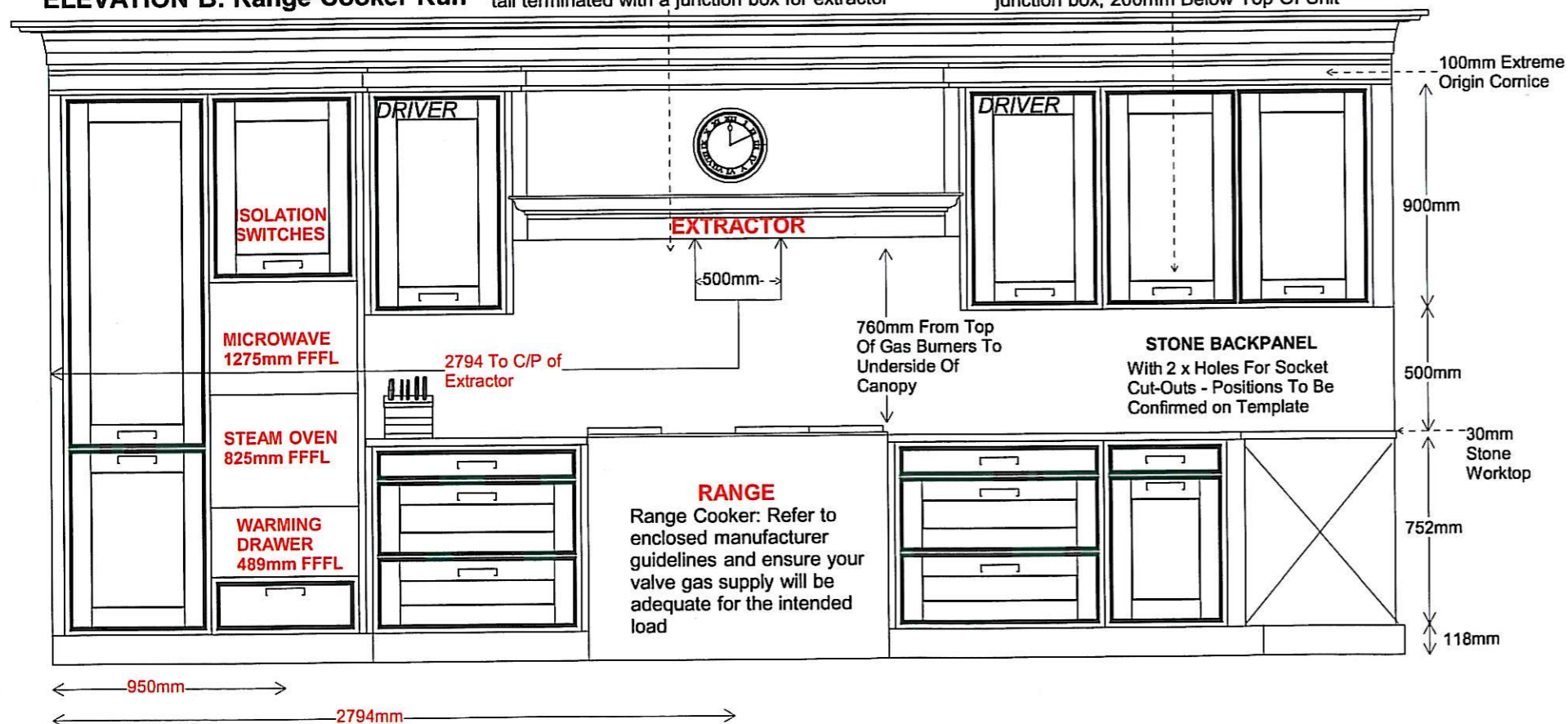

ELEVATION C: Island Prep Sink Run

Sink & Tap: H & C Supply Centered On Sink Base Unit 400mm From FFL Terminated With Ball O' Fix Valves Waste In Centre Of Sink Base 350mm From FFL

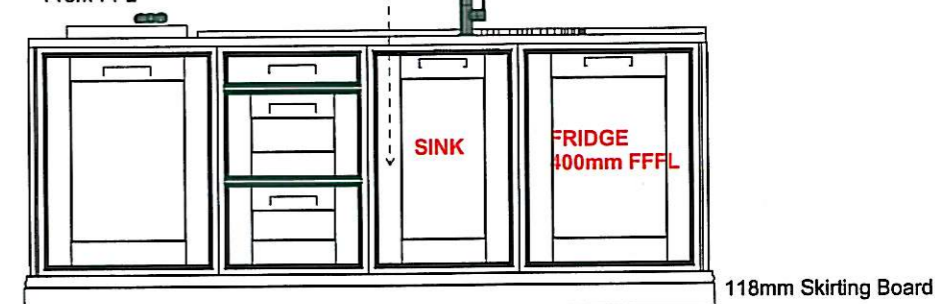

ELEVATION D: Island Wine Cooler Run



CLIENT: Octagon

DATE: 12th June 2014

SCALE: 1:25 @ A3

REF: X2K35995/REV05

ADDRESS: Haybarn, Dye House Road, Thursley

- For Linear Dimensions And Important Information Check Plan

- Please Note Dimensions Are From A Finished Floor Level

- See Site Preparation Pack For Appliance Loadings

- Appliances: Switched fused supplies are required for all appliances terminating in a flex outlet behind each appliance

- Worktops with upstands: Minimum clearance for sockets / switched gear is 50mm above upstand.

Ceiling Height 2600mm

Supplies For Island To Be 2nd Fixed After Furniture Has Been Constructed



EXTREME
WORLD CLASS DESIGN

CLIENT: Octagon

DATE: 12th June 2014

SCALE: 1:25 @ A3

REF: X2K35995/REV05

ADDRESS: Haybarn, Dye House Road, Thursley

IMPORTANT INFORMATION

- Design Based On Site Dimensions From 6th June 2014
- 30mm Stone Worktops With 100mm Upstands
- Stone Backpanel Behind Hob
-  Denotes LED Under Unit Lighting
- Boiler Dimensions TBC
- 6" Diameter or Equivalent Rigid Ducting Supplied and Fitted By Others
- Studwork Constructed By Others To Extreme Specification
- Positions Of Double Sockets Are Suggestions, Please Confirm With Client
- All Positions in handpainted Shaker In-Frame With Cockbead
- Skirting board on Island with Plinth Below Remaining Cabinets
- All Cabinets Painted In Farrow & Ball 'Manor House Grey'

SIGNATURE: _____

DATE: _____

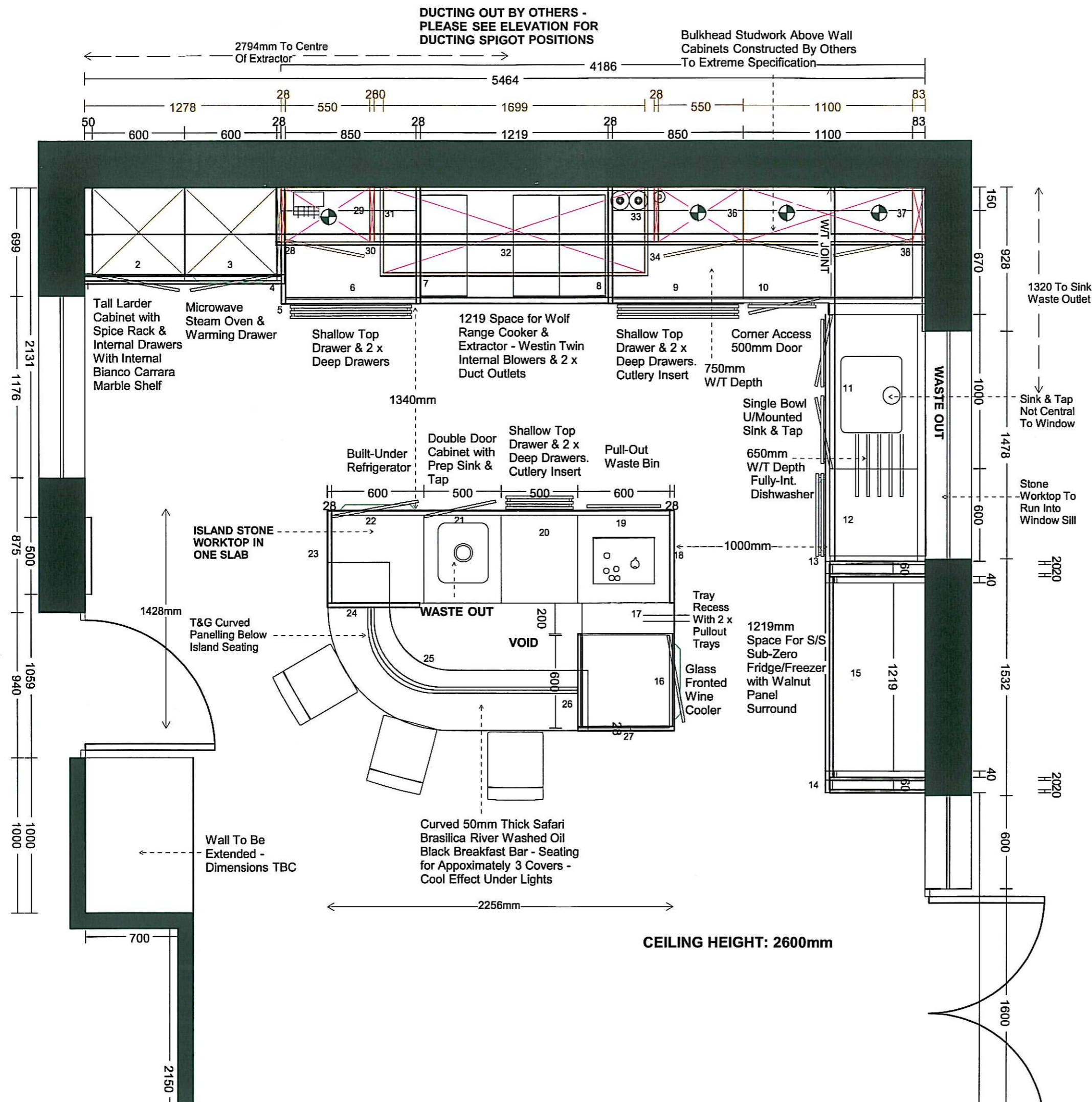

EXTREME
WORLD CLASS DESIGN