

USV-100

USV-250

## Binary Valves

The USV-100 provides alternating outputs from a single input port. The valve has two outputs which are selected alternately by applying a pulsing, on-off air signal to the input port. USV-100 will not function properly with a sustained signal.

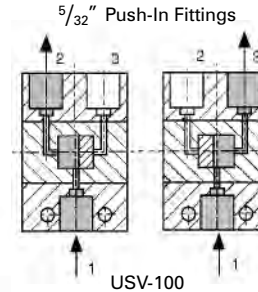

When pressure is applied to port 1, it flows through the valve to provide an output at port 2. When the pressure is released from port 1, the valve changes over so that when pressure is next applied at port 1, air flows out through port 3. Release of the pressure again changes the valve back to its original position. Therefore, each time pressure is applied and released to port 1, outputs 2 and 3 change over. **Note:** The air signal must be fully exhausted to enable the valve to change over properly.

USV-100 Dimensions

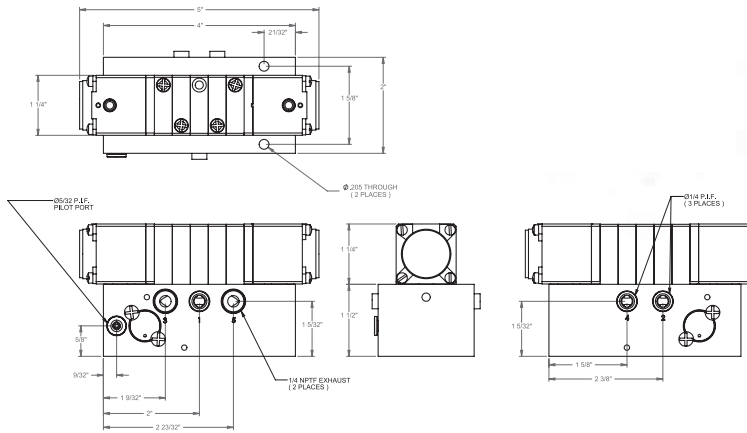
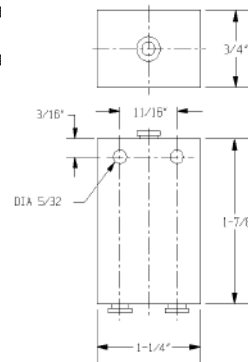

Technical Specification	100 Model	250 Model
Operating Pressure	35-100PSI	35-100PSI
Flow to atmosphere	4 SCFM @ 100 PSI	36.9 SCFM @ 100 PSI
Permissible Mediums	Air and Inert Gas	Air and Inert Gas
Ambient Temp. Range	10°F to 120°F	10°F to 120°F
Lubrication	Recommended	Not necessary
Flow		$C_v = 0.75$