

CP12 Fitting Guide

1 Remove headrest from seat. *Caution, the headrest stalks can be coated with a small amount of grease.*

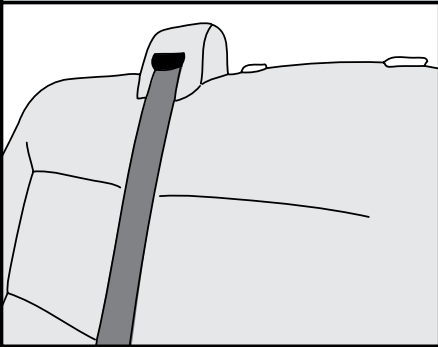

2 Undo central Velcro and place cover over seat. Pull the cover firmly over the seat. *Note, the gap between the back of the seat and the vehicle's bulkhead can be tight, force the cover into place one side at a time.*

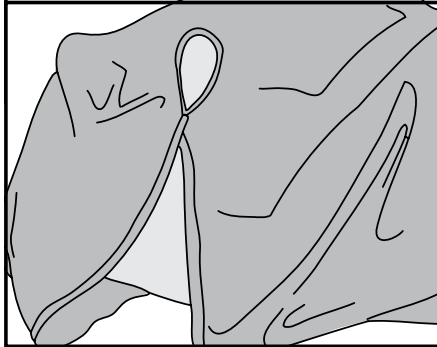

3 Align headrest plastic insertion points with the holes in the seat cover.

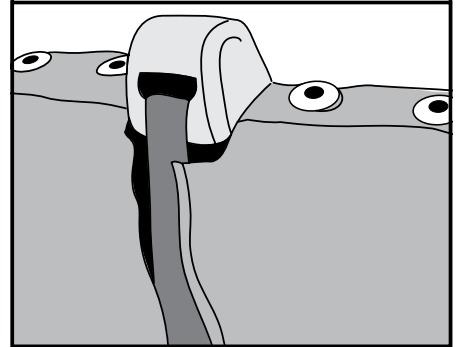

4 Pull tight and fasten central Velcro from top to bottom, keeping it as equal and square as possible.

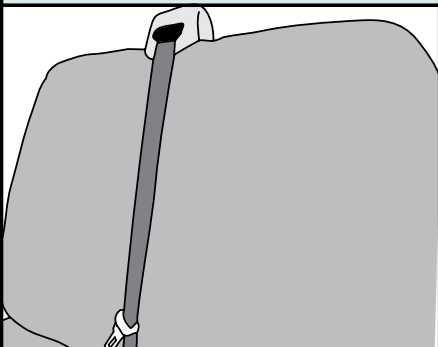

5 Pull the front of the cover down and push the two "Tuck-in" pouches between the back and the base of the seat.

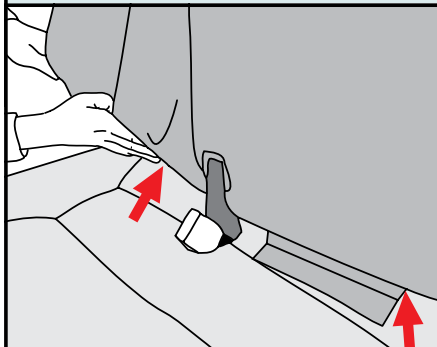

6 Pull the base part of the cover over the base cushion of the seat, allowing the elasticated apron to wrap around underneath seat.

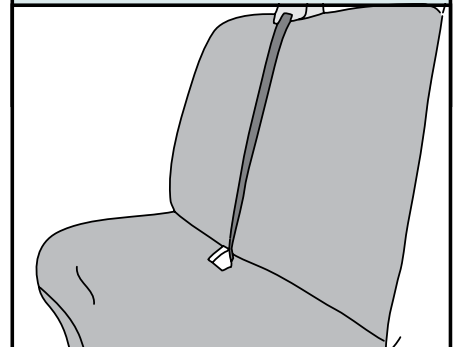

7 Reattach the headrests, and you're done.

