

DRAWING NOTES - GENERAL:

- DO NOT ALTER THIS DRAWING.
- THIS IS A REFERENCE DRAWING ONLY.
- SEE SolidWorks FILE FOR DETAILS
- IF IN DOUBT ASK.

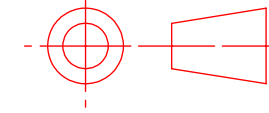

THIS IS A CAD DRAWING & MUST  
NOT BE ALTERED MANUALLY  
3RD ANGLE PROJECTION

ISSUE HISTORY ONLY - SEE TITLE BOX FOR LATEST ISSUE

ISSUE:	DATE:	CHANGE:
-	00.00.0000	-

LATEST ISSUE

ISSUE:	DATE:	DESCRIPTION:
A	01/08/2008	Pre-Production

CHANGE:  
-



TITLE: Tap Off Unit Std - 32A 5M  
PART REFERENCE: UTS35

Client DWG No. SK5314-1  
RA DWG No. RA 1059-064\_GA

SHEET No.  
1 of 2

A3

MATERIAL: -  
FINISH: -

PLASTECH Ltd.  
Unit 4, Ricebridge Works, Brighton Road  
Bolney, West Sussex, England - RH17 5NA  
TEL: 01444 881960 FAX: 01444 881244  
E-MAIL: mark@plastch.com  
WEB: www.plastch.com

Tolerances:  
Whole numbers  $\pm 0.4$   
1 decimal place  $\pm 0.2$   
2 decimal places  $\pm 0.05$

Angles  $\pm 1^\circ$   
Unless Stated

THIS DRAWING MUST NOT BE USED FOR MANUFACTURE UNLESS  
SPECIFICALLY STATED.

THIS DRAWING IS CONFIDENTIAL AND MUST NOT BE COPIED OR  
DISCLOSED WITHOUT PRIOR WRITTEN CONSENT.

DIMENSIONS IN mm

DRAWN:  
NDR

CHECKED:  
-

SCALE:  
1:1@A3

DATE:  
01/08/2008

PROJECT No.  
RA 1059

**DRAWING NOTES - GENERAL:**

- DO NOT ALTER THIS DRAWING.
- THIS IS A REFERENCE DRAWING ONLY.
- SEE SolidWorks FILE FOR DETAILS
- IF IN DOUBT ASK.

ITEM NO.	PART NUMBER	Std_Part_Ref.	QTY.
1	RA1059-031_PT - Plug Base 1-1	YUF0014	1
2	RA1059-010_PT - Plug Cover - Gray	YUF0019	1
3	RA1059-018_PT - Plug to Casing Earth Blade	ZUF0305	1
4	3.5 x 9.5 Rec Pan Steel Type B ST	ZUF0203	3
5	RA1059-072_PT - Plug to Busbar Blade	ZUF0310	2

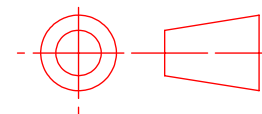

THIS IS A CAD DRAWING & MUST  
NOT BE ALTERED MANUALLY  
3RD ANGLE PROJECTION

**ISSUE HISTORY ONLY - SEE TITLE BOX FOR LATEST ISSUE**

ISSUE:	DATE:	CHANGE:
-	00.00.0000	-

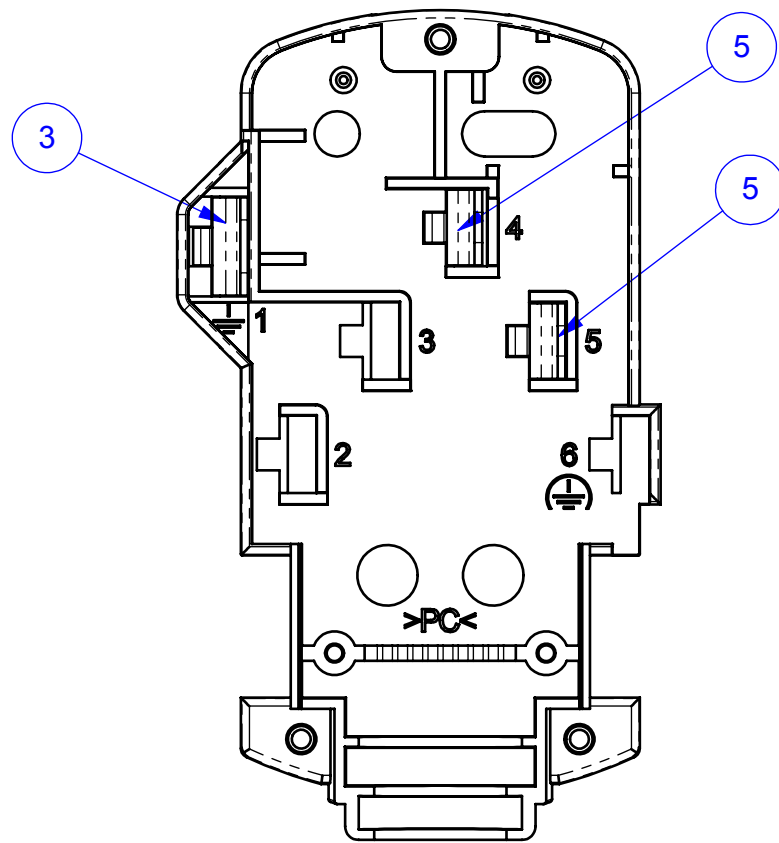
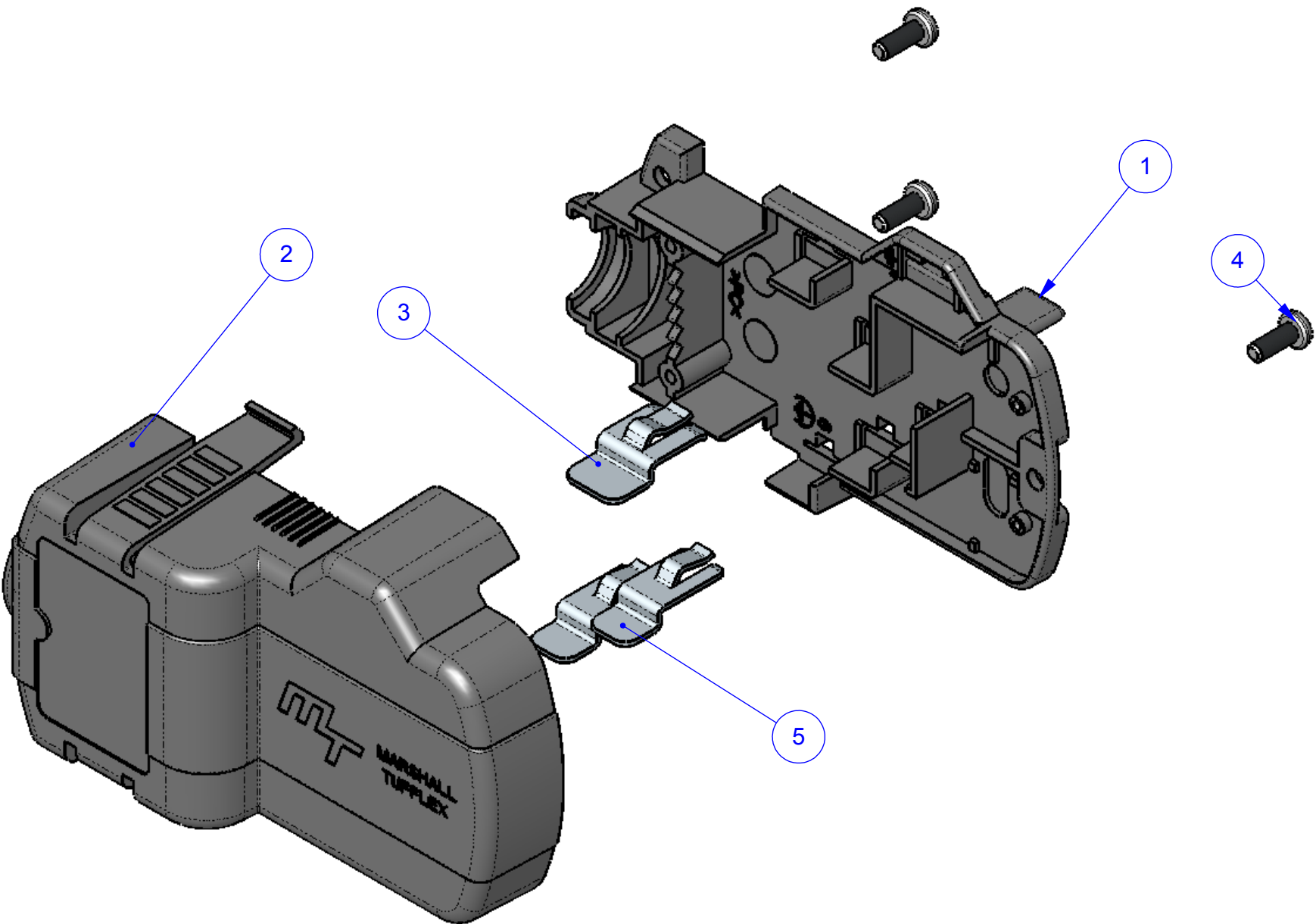

**LATEST ISSUE**

ISSUE:	DATE:	DESCRIPTION:
A	01/08/2008	Pre-Production

CHANGE:  
-



TITLE: Tap Off Unit Std - 32A 5M  
PART REFERENCE: UTS35

Client DWG No. SK5314-1	SHEET No. 2 of 2	A3
RA DWG No. RA 1059-064_GA		

MATERIAL: -	DRAWN: NDR
FINISH: -	CHECKED: -
PLASTECH Ltd. Unit 4, Ricebridge Works, Brighton Road Bolney, West Sussex, England - RH17 5NA TEL: 01444 881960 FAX: 01444 881244 E-MAIL: mark@plastch.com WEB: www.plastch.com	Tolerances: Whole numbers ± 0.4 1 decimal place ± 0.2 2 decimal places ± 0.05  Angles ± 1° Unless Stated
THIS DRAWING MUST NOT BE USED FOR MANUFACTURE UNLESS SPECIFICALLY STATED.	SCALE: 1:1@A3
THIS DRAWING IS CONFIDENTIAL AND MUST NOT BE COPIED OR DISCLOSED WITHOUT PRIOR WRITTEN CONSENT.	DATE: 01/08/2008
DIMENSIONS IN mm	PROJECT No. RA 1059

